



WORKBENCH SPIRAL IL-5400-V.2.0 WORKBENCH LIGHTING



Highly precise inspection lamp



AVANTAGES

- Comfortable: limited eye fatigue and absence of heat dissipation at the lamp head level.
- Ergonomic: different working positions are possible, limiting neck and lower back pain.
- Evolutive: conceived to hold several accessories such as magnifiers and a lightbox.

The Spiral IL-5400 is a highly precise inspection lamp that has been designed collaboratively with the leaders of the watchmaking sector. Its ultra-directional light and its high optical signal-to-noise allow an optimum lighting of the working zone with 5400 K colour temperature.

Thanks to the lamp hinge (-20° to 40°), it is possible to examine samples under different lighting angles. The inspection position is easily configurable to meet different user needs. The hollowed lamp head does not dissipate heat and has been conceived to hold a removable magnifier as well as an optional lightbox. The lightbox allows precise inspection regardless of the ambient light. More than 40% productivity gain can be made on quality control operations when using the Spiral IL-5400 lighting system.

L.E.S.S. lighting systems exhibit the same optical properties (colour temperature, uniformity, directionality), regardless of the product line (microscopy, machine vision or workbench lighting). The light quality remains constant throughout the system's lifespan. This consistency gives a stable benchmark at two different levels: over time as well as on the whole assembly line. This allows overall standardisation and time-saving operations.

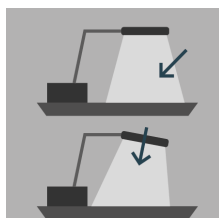

L.E.S.S. SA

Avenue de Longemalle 13
CH-1020 Renens, Suisse
Tél : +41 21 552 07 10
info@less-sa.com

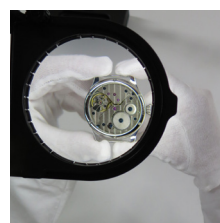
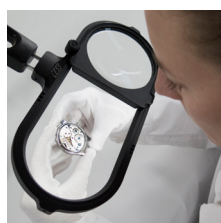



SPIRAL IL-5400-V.2.0 WORKBENCH LIGHTING

Highly precise inspection lamp

TECHNICAL DATA

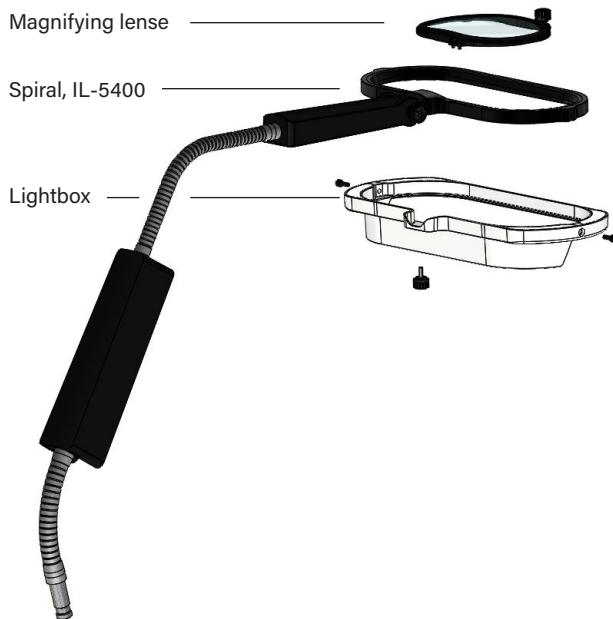

Reference	IL-5400
Product line	Workbench lighting
Color temperature	5400 K
Illumination (at 15 cm)	> 2 500 lx
Energy consumption	approx. 10 W
Inner diameter	260 x 100 mm 10,2 x 3,4 inches
External dimension	300 x 145 mm 11,8 x 5,7 inches
Articulated arm	800 mm 31,5 inches
Workbench interface diameter	16 mm 0,6 inches
Lifetime	> 20 000 hours ¹
Electronic control unit	Built-in
Power switch	On / Off
Light intensity control	None
Operating ambient temperature	0 - 40 °C
Hinge tilt	-20° to 40°
Lightbox	Yes
Magnifying lens	Yes
External power supply	DC 12 V

¹The lifetime of the lighting is defined during normal use. Results may vary depending on environmental conditions and/or specific customer use.

Ultra uniform light intensity profile

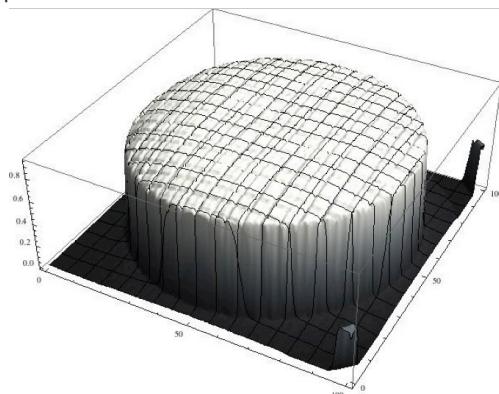

ACCESSORIES

- Magnifying lens: it renders a detailed view of the sample with a x2 magnification, allowing a magnified observation with both eyes.
- Lightbox: it extends the rim of the light ring, isolates the inspection area from ambient light and enhances lighting uniformity in a three-dimensional space.
- Base system: it provides a steady base for the lamp on a flat surface when the lamp is not directly fixed to the workbench.

www.less-sa.com

less 
BE BRILLIANT



RISK CLASS 0
EN 62471: 2006

EYE-SAFE
CLASS 1 LASER PRODUCT
ICE 60825-1 2014-05

